

**PLAN**

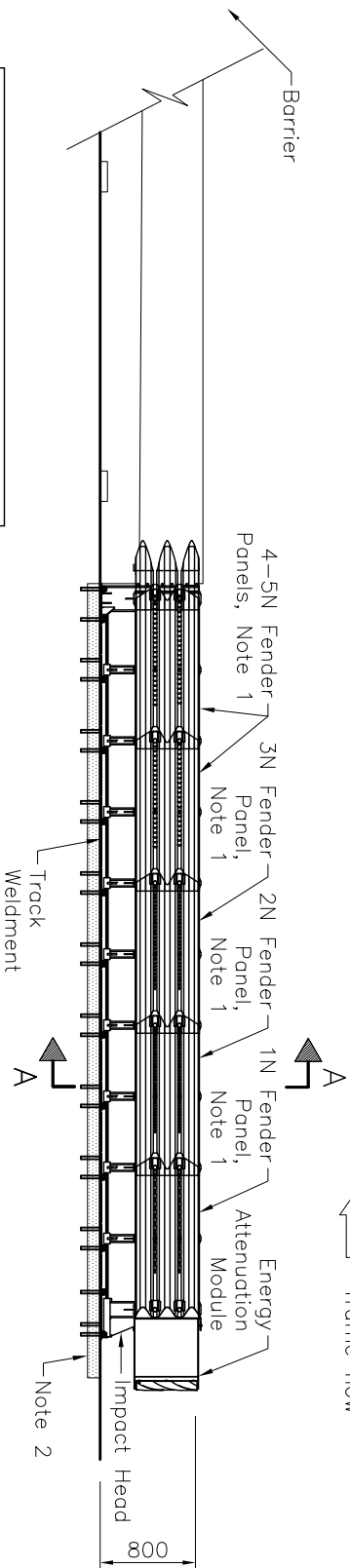

**ELEVATION**

TABLE 1		
SYSTEM CONFIGURATION	TL-2	TL-3
SYSTEM LENGTH	4147	6403

- 1 TL-2 system consists of 1N, 3N and 4-5N Panels.
  - 2 When the system is placed on a concrete pad, the pad shall be according to OPSD 923.001
  - 3 Anchors shall be according to the manufacturer's specifications.
- A Delineation shall be according to OPSD 984.203.

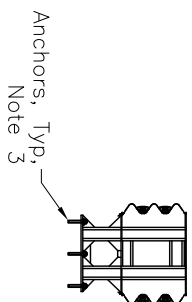

- B The system depicted here is a proprietary product.
- C System configuration meets AASHTO MASH TL-2 and TL-3
- D All dimensions are in millimetres unless otherwise shown.

MINISTRY OF TRANSPORTATION ONTARIO DRAWING		April 2024	Rev 1
<b>ENERGY ATTENUATOR, CRASH CUSHION DELTA CRASH CUSHION INSTALLATION – TEMPORARY UNIDIRECTIONAL</b>			
		MTOD – 923.512	