

**PLAN**

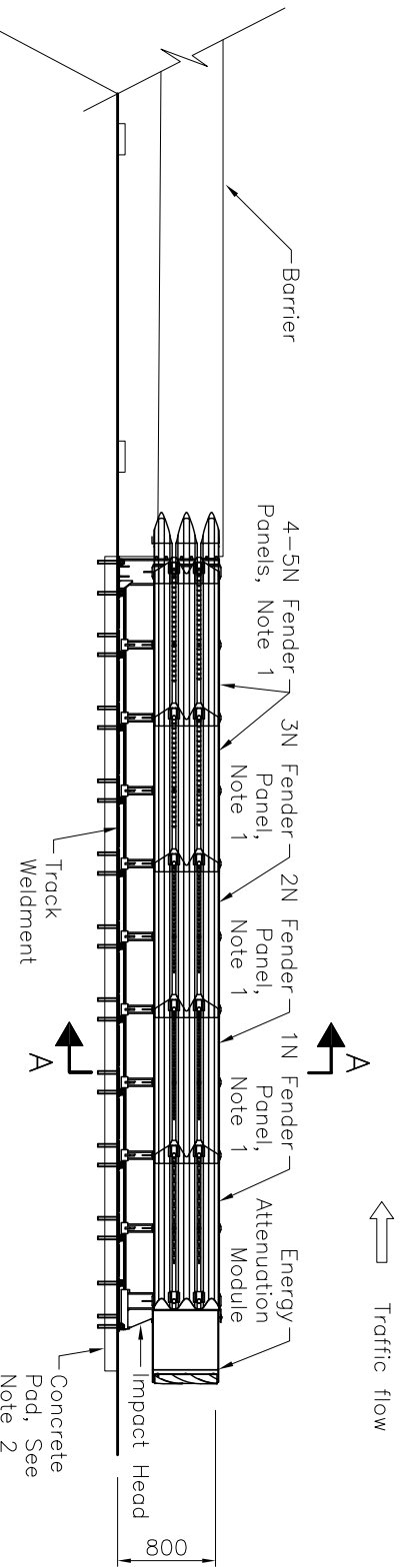

**ELEVATION**

TABLE 1	
SYSTEM CONFIGURATION	TL-2 TL-3
SYSTEM LENGTH	4147 6403

**NOTES:**

- 1 TL-2 system consists of 1N, 3N and 4-5N Panels.
- 2 The system shall be anchored to a concrete pad according to OPSD 923.001.
- 3 Anchors shall be according to the manufacturer's specifications.
- A Delineation shall be according to OPSD 984.203.

- B The system depicted here is a proprietary product.
- C System configuration meets AASHTO MASH TL-2 and TL-3
- D All dimensions are in millimetres unless otherwise shown.

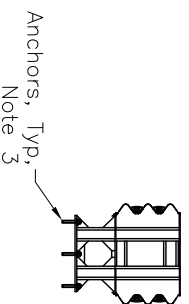

**SECTION A-A**

MINISTRY OF TRANSPORTATION ONTARIO DRAWING	April 2024	Rev 1
<b>ENERGY ATTENUATOR, CRASH CUSHION DELTA CRASH CUSHION INSTALLATION – PERMANENT UNIDIRECTIONAL</b>		
MTOD – 923.510		